

EKVM 72/75-Z52

Enlarging cable gland, brass, DIN 89280, M72-M75

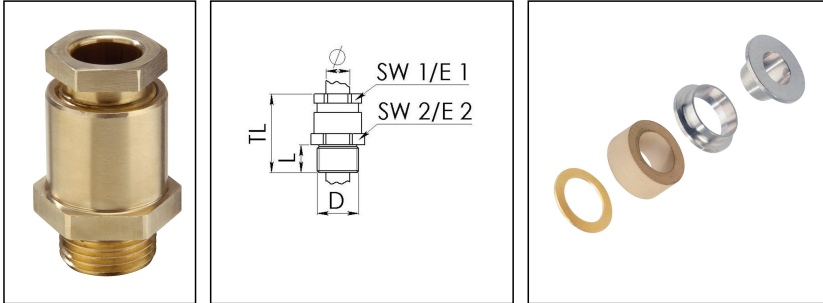

Product illustrations are exemplary and may differ from the chosen product. Further variants and individual customization, we will gladly provide you on request.



Material cable gland	Brass
Material sealing gasket	EPDM
Material earthing insert	Brass chromium-plated
Temp. range min	-40 °C
Temp. range max	100 °C
Protection class	IP54
Thread type	M
Ø Connection thread D	75
Lead	1,5
Length screw-in thread L	16 mm
Ø cable diameter min	48 mm
Ø cable diameter max	52,5 mm
Key width SW1	70 mm
Key width SW2	82 mm
Collar diameter E1	78 mm
Collar diameter E2	92 mm
Total length TL	69 mm
Install. torques fitting	20 N m
Install. torques cap nut	15 N m
Surface	Bright
Order no. bright	10016328
Type	EKVM 72/75-Z52
Packing unit	1
ETIM-Classification	EC000441

Your Contact:

WISKA Hoppmann GmbH

Kisdorfer Weg 28 · 24568 Kaltenkirchen · Germany

☎ +49-4191-508-0 · 📠 +49-4191-508-209

contact@wiska.de · www.wiska.com

Recommended accessories

GM 72

50011425

21.08.2018

Your Contact:

WISKA Hoppmann GmbH

Kisdorfer Weg 28 · 24568 Kaltenkirchen · Germany

☎ +49-4191-508-0 · 📠 +49-4191-508-209

contact@wiska.de · www.wiska.com

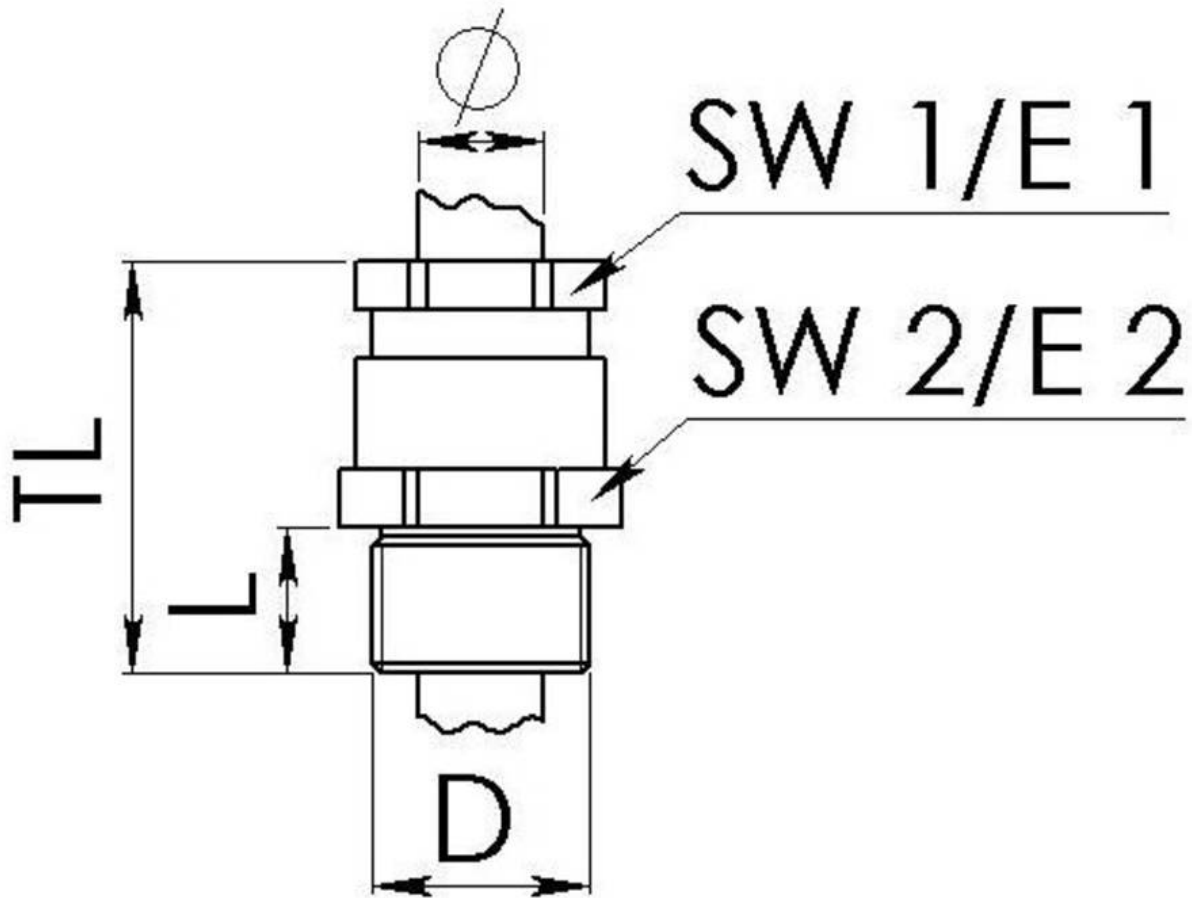

Your Contact:

WISKA Hoppmann GmbH

Kisdorfer Weg 28 · 24568 Kaltenkirchen · Germany

☎ +49-4191-508-0 · 📠 +49-4191-508-209

contact@wiska.de · www.wiska.com