

EKVM 30/25-W20

Cable gland, brass, DIN 89280, M30-M25



Product illustrations are exemplary and may differ from the chosen product. Further variants and individual customization, we will gladly provide you on request.



Material cable gland	Brass
Material sealing gasket	EPDM
Temp. range min	-40 °C
Temp. range max	100 °C
Protection class	IP54
Thread type	M
Ø Connection thread D	25
Lead	1,5
Length screw-in thread L	12 mm
Ø cable diameter min	18 mm
Ø cable diameter max	20,5 mm
Key width SW1	30 mm
Key width SW2	36 mm
Collar diameter E1	33 mm
Collar diameter E2	39 mm
Total length TL	51 mm
Install. torques fitting	10 N m
Install. torques cap nut	10 N m
Surface	Bright
Order no. bright	10016395
Type	EKVM 30/25-W20
Packing unit	1

20.01.2019

Your Contact:

WISKA Hoppmann GmbH

Kisdorfer Weg 28 · 24568 Kaltenkirchen · Germany

☎ +49-4191-508-0 · 📠 +49-4191-508-209

contact@wiska.de · www.wiska.com

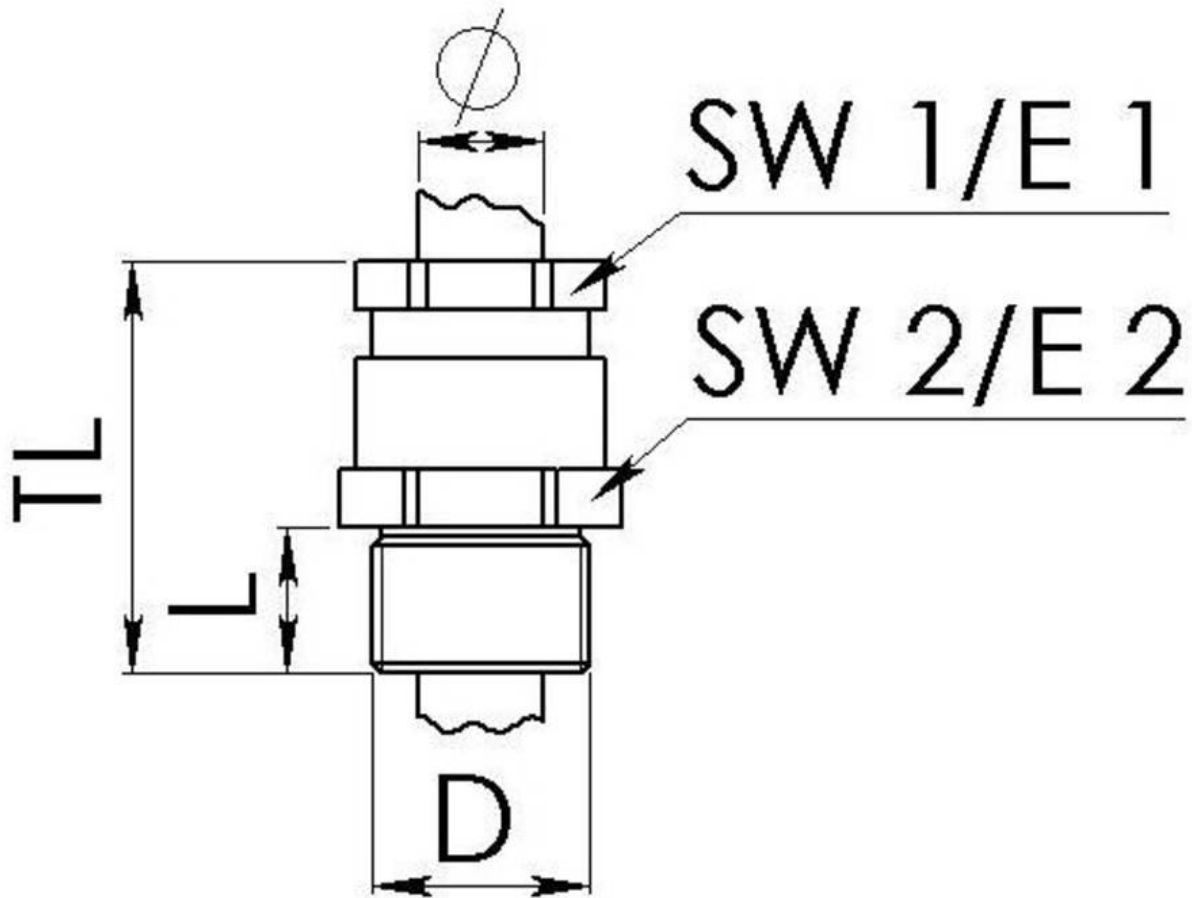

Your Contact:

WISKA Hoppmann GmbH

Kisdorfer Weg 28 · 24568 Kaltenkirchen · Germany

☎ +49-4191-508-0 · 📠 +49-4191-508-209

contact@wiska.de · www.wiska.com