

KVMS 80-W61/Cr

Cable gland, brass chromed-plated, similar to DIN 89280, M80

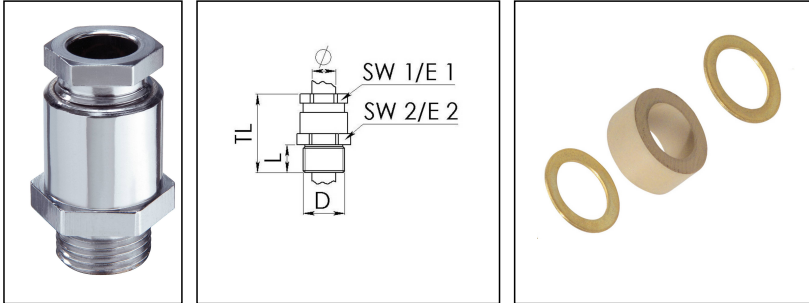

Product illustrations are exemplary and may differ from the chosen product. Further variants and individual customization, we will gladly provide you on request.



Material cable gland	Brass chromium-plated
Material sealing gasket	EPDM
Temp. range min	-40 °C
Temp. range max	100 °C
Protection class	IP54
Thread type	M
Ø Connection thread D	80
Lead	2
Length screw-in thread L	18 mm
Ø cable diameter min	59 mm
Ø cable diameter max	62 mm
Key width SW1	85 mm
Key width SW2	90 mm
Collar diameter E1	92 mm
Collar diameter E2	100 mm
Total length TL	79 mm
Install. torques fitting	30 N m
Install. torques cap nut	30 N m
Advice	* Similar to DIN 89280
Surface	Chromium-plated
Order no. chrome-plated	10016452
Type	KVMS 80-W61/Cr
Packing unit	1
ETIM-Classification	EC000441

Your Contact:

WISKA Hoppmann GmbH

Kisdorfer Weg 28 · 24568 Kaltenkirchen · Germany

☎ +49-4191-508-0 · 📠 +49-4191-508-209

contact@wiska.de · www.wiska.com

Recommended accessories

GM 80/Cr

10011858

22.11.2018

Your Contact:

WISKA Hoppmann GmbH

Kisdorfer Weg 28 · 24568 Kaltenkirchen · Germany

☎ +49-4191-508-0 · 📠 +49-4191-508-209

contact@wiska.de · www.wiska.com

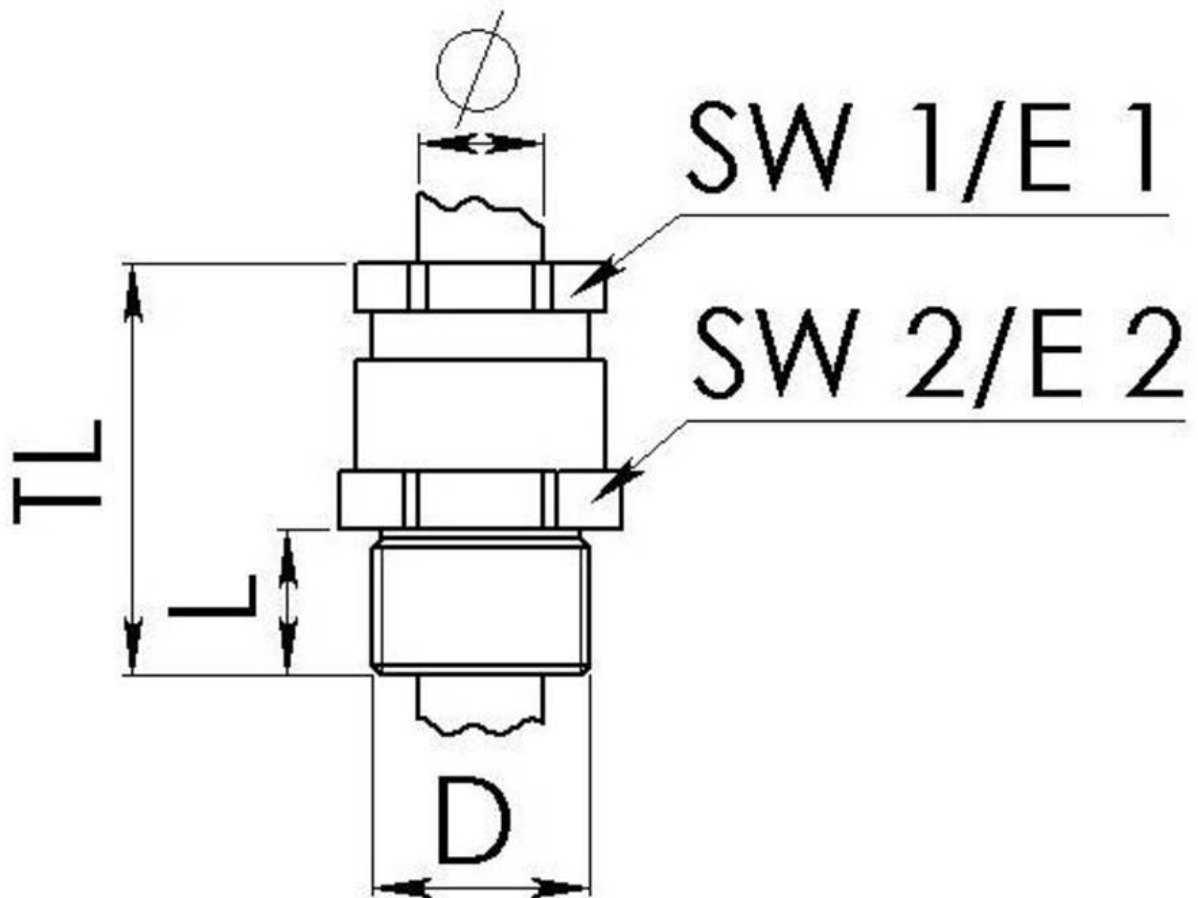

Your Contact:

WISKA Hoppmann GmbH

Kisdorfer Weg 28 · 24568 Kaltenkirchen · Germany

☎ +49-4191-508-0 · 📠 +49-4191-508-209

contact@wiska.de · www.wiska.com