

## EKVM 24/25 VG B 24-10

Cable gland DIN 89280, brass, earthing insert VG 88773, M24-25

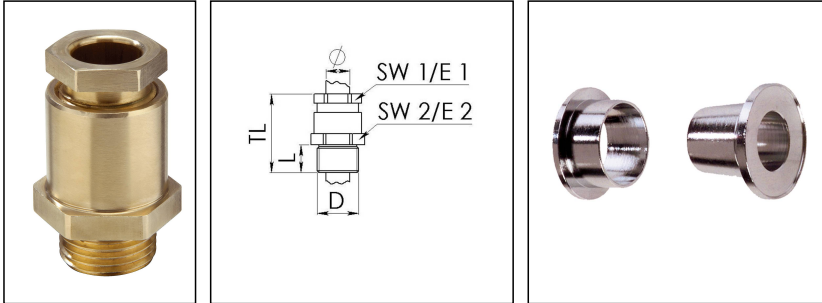

Product illustrations are exemplary and may differ from the chosen product. Further variants and individual customization, we will gladly provide you on request.



<b>Material cable gland</b>	Brass
<b>Material earthing insert</b>	Brass chromium-plated
<b>Temp. range min</b>	-30 °C
<b>Temp. range max</b>	80 °C
<b>Protection class</b>	IP30
<b>Thread type</b>	M
<b>Ø Connection thread D</b>	25
<b>Lead</b>	1,5
<b>Length screw-in thread L</b>	11 mm
<b>Ø cable below cable shield</b>	0 mm - 10,6 mm
<b>Key width SW1</b>	24 mm
<b>Key width SW2</b>	29 mm
<b>Collar diameter E1</b>	26 mm
<b>Collar diameter E2</b>	32 mm
<b>Total length TL</b>	51 mm
<b>Surface</b>	Bright
<b>Order no. bright</b>	10016507
<b>Type</b>	EKVM 24/25 VG B 24-10
<b>Packing unit</b>	1

22.09.2018

Your Contact:

**WISKA Hoppmann GmbH**

Kisdorfer Weg 28 · 24568 Kaltenkirchen · Germany

☎ +49-4191-508-0 · 📠 +49-4191-508-209

contact@wiska.de · www.wiska.com

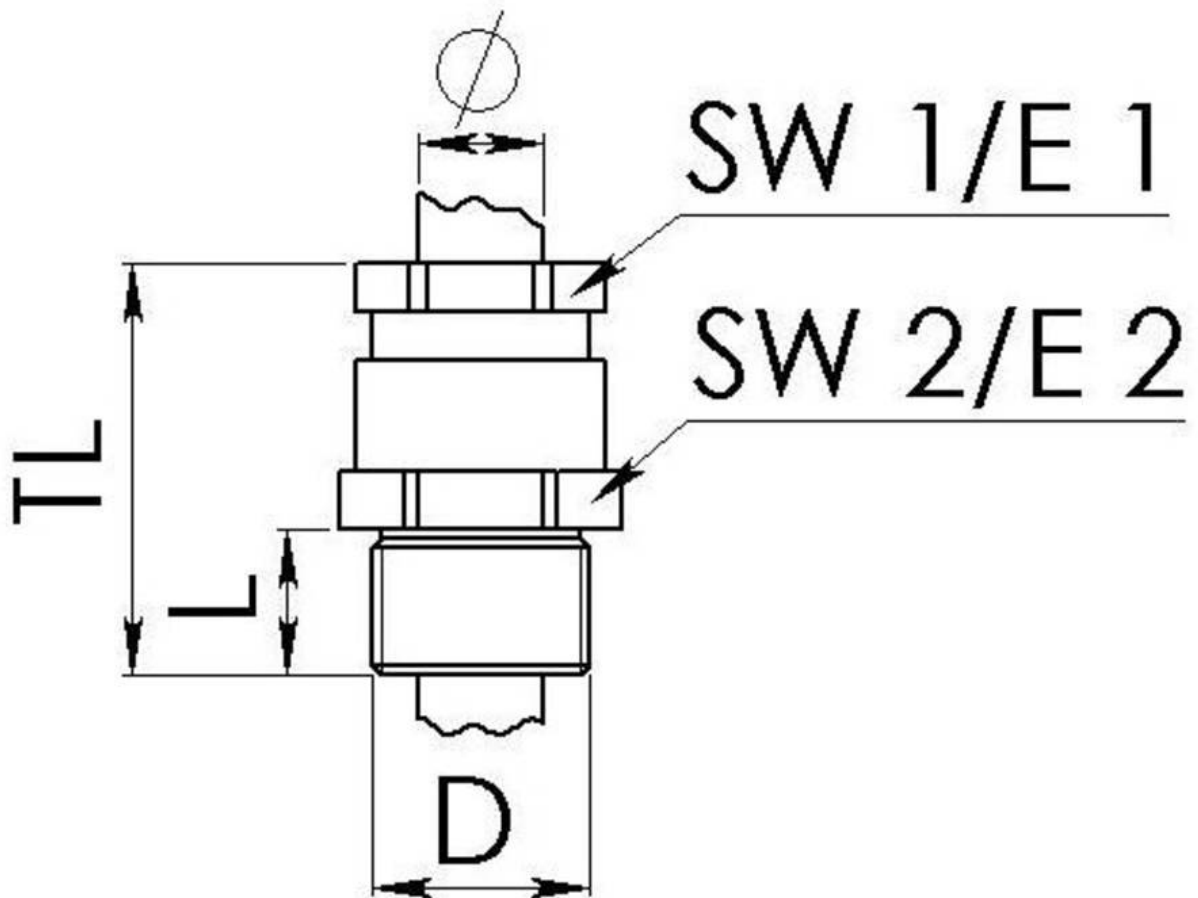

Your Contact:

**WISKA Hoppmann GmbH**

Kisdorfer Weg 28 · 24568 Kaltenkirchen · Germany

☎ +49-4191-508-0 · 📠 +49-4191-508-209

contact@wiska.de · www.wiska.com