

EKVM 30/32 VG B 30-16

Cable gland DIN 89280, brass, earthing insert VG 88773, M30-32

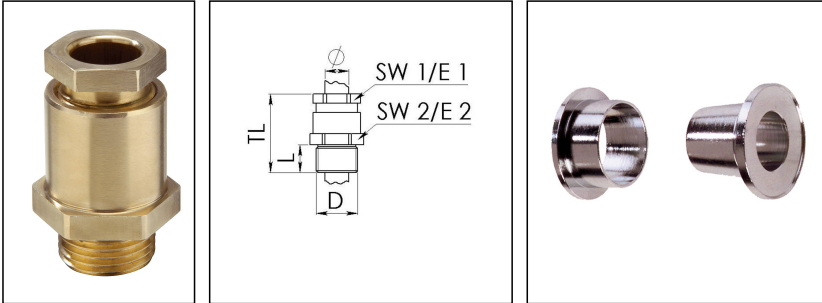

Product illustrations are exemplary and may differ from the chosen product. Further variants and individual customization, we will gladly provide you on request.



Material cable gland	Brass
Material earthing insert	Brass chromium-plated
Temp. range min	-30 °C
Temp. range max	80 °C
Protection class	IP30
Thread type	M
Ø Connection thread D	32
Lead	1,5
Length screw-in thread L	12 mm
Ø cable below cable shield	0 mm - 16,7 mm
Key width SW1	30 mm
Key width SW2	36 mm
Collar diameter E1	33 mm
Collar diameter E2	39 mm
Total length TL	51 mm
Surface	Bright
Order no. bright	10016513
Type	EKVM 30/32 VG B 30-16
Packing unit	1

16.12.2018

Your Contact:

WISKA Hoppmann GmbH

Kisdorfer Weg 28 · 24568 Kaltenkirchen · Germany

☎ +49-4191-508-0 · 📠 +49-4191-508-209

contact@wiska.de · www.wiska.com

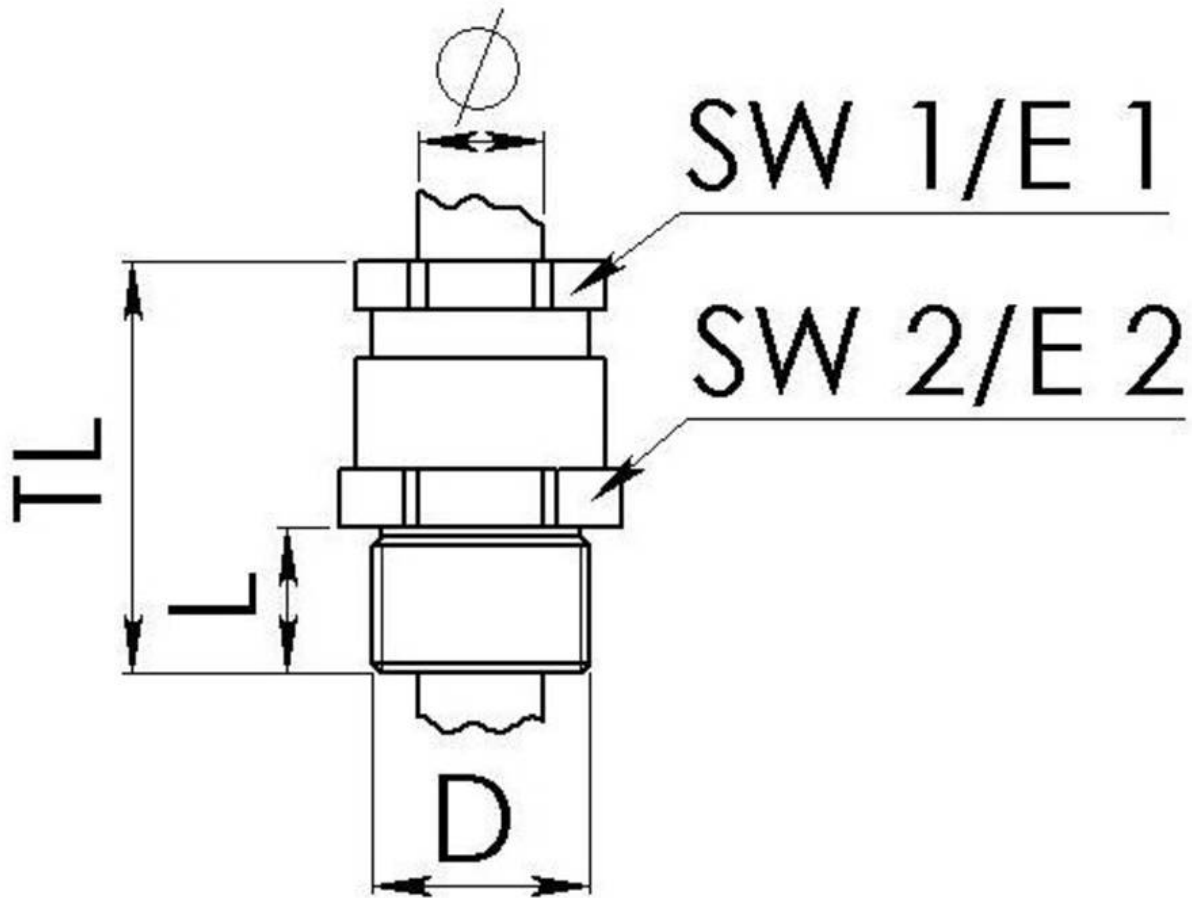

Your Contact:

WISKA Hoppmann GmbH

Kisdorfer Weg 28 · 24568 Kaltenkirchen · Germany

☎ +49-4191-508-0 · 📠 +49-4191-508-209

contact@wiska.de · www.wiska.com