

## KVMS 72-W52/Ni

Cable gland, brass nickel-plated, DIN 89280, M72

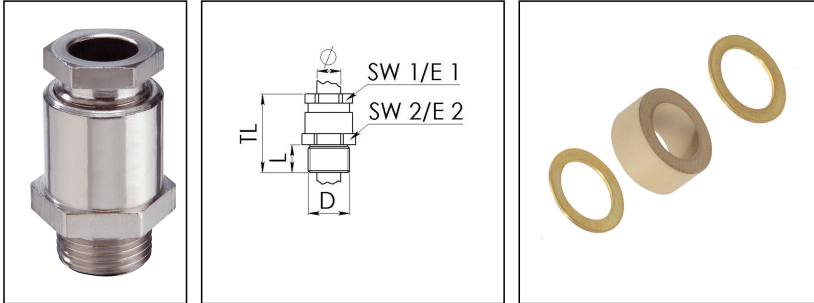

Product illustrations are exemplary and may differ from the chosen product. Further variants and individual customization, we will gladly provide you on request.



<b>Material cable gland</b>	Brass nickel-plated
<b>Material sealing gasket</b>	EPDM
<b>Temp. range min</b>	-40 °C
<b>Temp. range max</b>	100 °C
<b>Protection class</b>	IP54
<b>Thread type</b>	M
<b>Ø Connection thread D</b>	72
<b>Lead</b>	2
<b>Length screw-in thread L</b>	16 mm
<b>Ø cable diameter min</b>	48 mm
<b>Ø cable diameter max</b>	52,5 mm
<b>Key width SW1</b>	70 mm
<b>Key width SW2</b>	78 mm
<b>Collar diameter E1</b>	78 mm
<b>Collar diameter E2</b>	87 mm
<b>Total length TL</b>	73 mm
<b>Install. torques fitting</b>	20 N m
<b>Install. torques cap nut</b>	15 N m
<b>Surface</b>	Nickel-plated
<b>Order no. nickel-plated</b>	10016719
<b>Type</b>	KVMS 72-W52/Ni
<b>Packing unit</b>	1
<b>ETIM-Classification</b>	EC000441

Your Contact:

WISKA Hoppmann GmbH

Kisdorfer Weg 28 · 24568 Kaltenkirchen · Germany

☎ +49-4191-508-0 · 📠 +49-4191-508-209

contact@wiska.de · www.wiska.com

Recommended accessories

**GM 72/Ni**

30070555

21.10.2018

Your Contact:

**WISKA Hoppmann GmbH**

Kisdorfer Weg 28 · 24568 Kaltenkirchen · Germany

☎ +49-4191-508-0 · 📠 +49-4191-508-209

contact@wiska.de · www.wiska.com

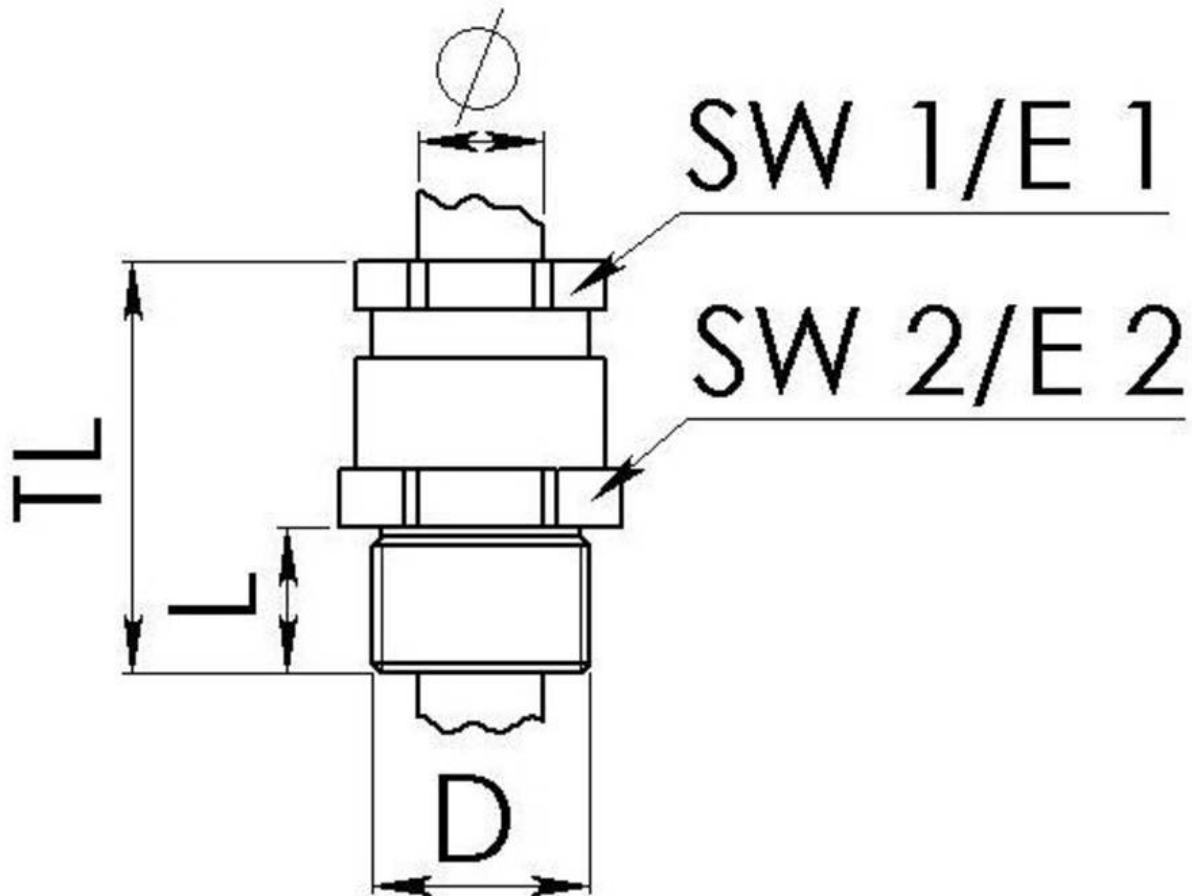

Your Contact:

**WISKA Hoppmann GmbH**

Kisdorfer Weg 28 · 24568 Kaltenkirchen · Germany

☎ +49-4191-508-0 · 📠 +49-4191-508-209

contact@wiska.de · www.wiska.com