

KVMS 24-Z16/Ni

Cable gland, brass nickel-plated, DIN 89280, M24

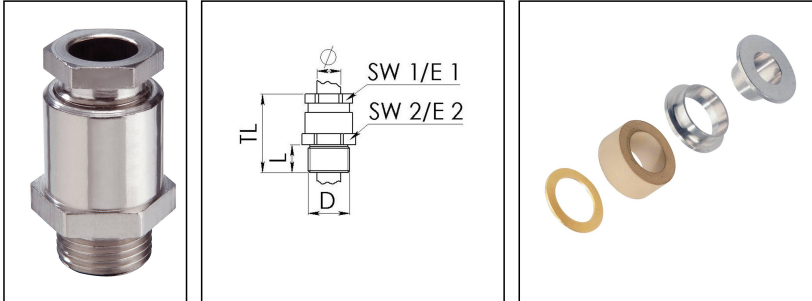

Product illustrations are exemplary and may differ from the chosen product. Further variants and individual customization, we will gladly provide you on request.



| | |
|--------------------------|-----------------------|
| Material cable gland | Brass nickel-plated |
| Material sealing gasket | EPDM |
| Material earthing insert | Brass chromium-plated |
| Temp. range min | -40 °C |
| Temp. range max | 100 °C |
| Protection class | IP54 |
| Thread type | M |
| Ø Connection thread D | 24 |
| Lead | 1,5 |
| Length screw-in thread L | 11 mm |
| Ø cable diameter min | 14 mm |
| Ø cable diameter max | 16,5 mm |
| Key width SW1 | 24 mm |
| Key width SW2 | 29 mm |
| Collar diameter E1 | 26 mm |
| Collar diameter E2 | 32 mm |
| Total length TL | 49 mm |
| Install. torques fitting | 10 N m |
| Install. torques cap nut | 10 N m |
| Surface | Nickel-plated |
| Order no. nickel-plated | 10016731 |
| Type | KVMS 24-Z16/Ni |
| Packing unit | 1 |
| ETIM-Classification | EC000441 |

Your Contact:

WISKA Hoppmann GmbH

Kisdorfer Weg 28 · 24568 Kaltenkirchen · Germany

☎ +49-4191-508-0 · 📠 +49-4191-508-209

contact@wiska.de · www.wiska.com

Recommended accessories

GM 24/Ni

10013175

20.08.2018

Your Contact:

WISKA Hoppmann GmbH

Kisdorfer Weg 28 · 24568 Kaltenkirchen · Germany

☎ +49-4191-508-0 · 📠 +49-4191-508-209

contact@wiska.de · www.wiska.com

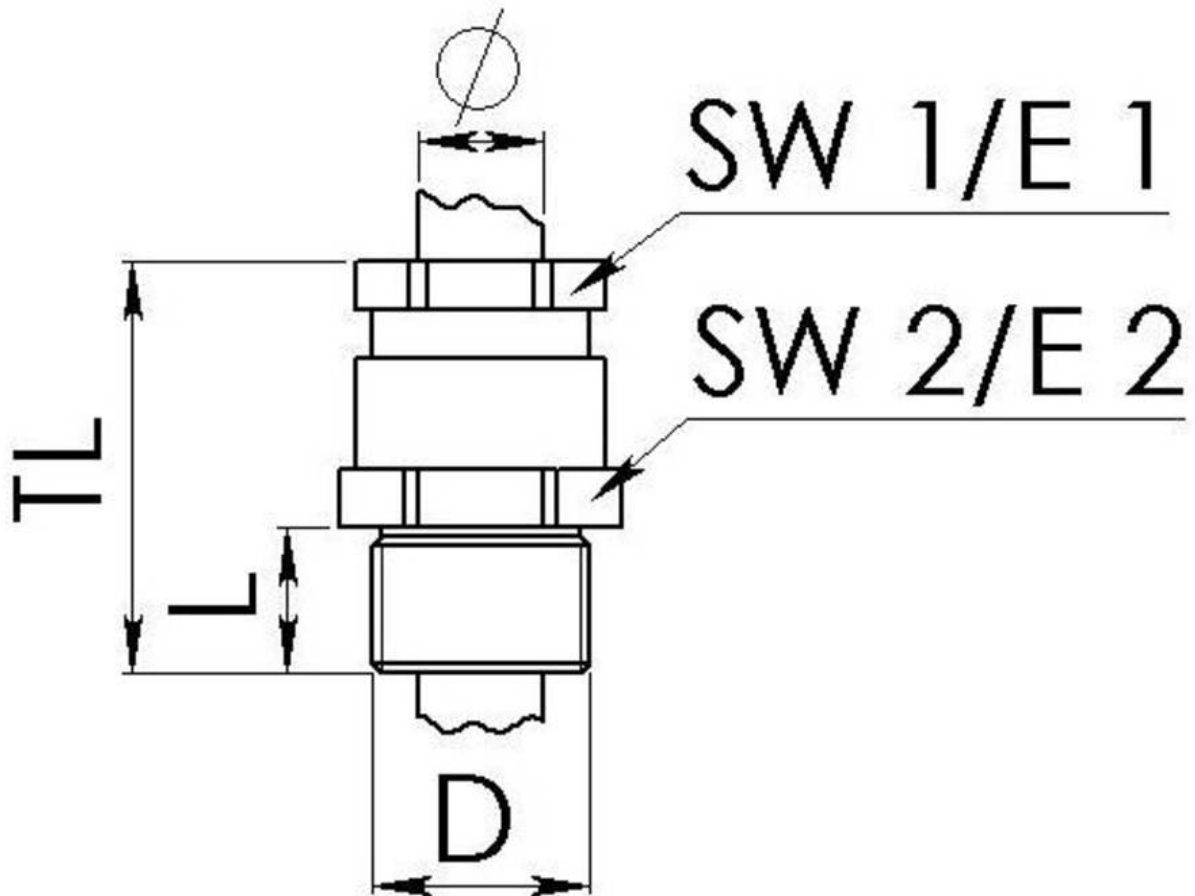

Your Contact:

WISKA Hoppmann GmbH

Kisdorfer Weg 28 · 24568 Kaltenkirchen · Germany

☎ +49-4191-508-0 · 📠 +49-4191-508-209

contact@wiska.de · www.wiska.com