

## EKVM 24/25-Z10A/Cr

Enlarging cable gland, brass chromed-plated, DIN 89280, M24-M25



Product illustrations are exemplary and may differ from the chosen product. Further variants and individual customization, we will gladly provide you on request.



Material cable gland	Brass chromium-plated
Material sealing gasket	EPDM
Material earthing insert	Brass chromium-plated
Temp. range min	-40 °C
Temp. range max	100 °C
Protection class	IP54
Thread type	M
Ø Connection thread D	25
Lead	1,5
Length screw-in thread L	11 mm
Ø cable diameter min	8 mm
Ø cable diameter max	10,5 mm
Key width SW1	24 mm
Key width SW2	29 mm
Collar diameter E1	26 mm
Collar diameter E2	32 mm
Total length TL	47 mm
Install. torques fitting	10 N m
Install. torques cap nut	10 N m
Surface	Chromium-plated
Order no. chrome-plated	10016901
Type	EKVM 24/25-Z10A/Cr
Packing unit	1
ETIM-Classification	EC000441

Your Contact:

WISKA Hoppmann GmbH

Kisdorfer Weg 28 · 24568 Kaltenkirchen · Germany

☎ +49-4191-508-0 · 📠 +49-4191-508-209

contact@wiska.de · www.wiska.com

Recommended accessories

**GM 24/Cr**

10011532

16.08.2018

Your Contact:

**WISKA Hoppmann GmbH**

Kisdorfer Weg 28 · 24568 Kaltenkirchen · Germany

☎ +49-4191-508-0 · 📠 +49-4191-508-209

contact@wiska.de · www.wiska.com

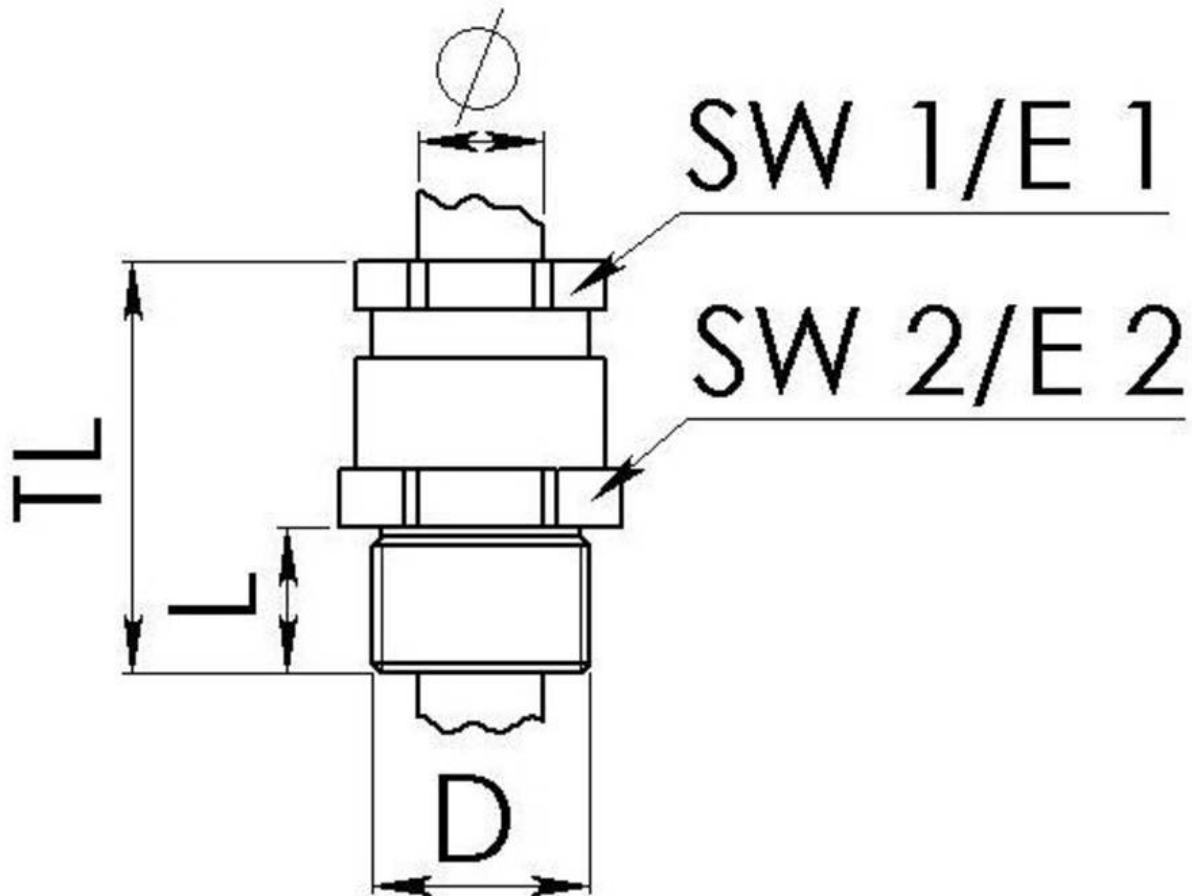

Your Contact:

**WISKA Hoppmann GmbH**

Kisdorfer Weg 28 · 24568 Kaltenkirchen · Germany

☎ +49-4191-508-0 · 📠 +49-4191-508-209

contact@wiska.de · www.wiska.com