

EKVM 36/40-Z22/Cr

Enlarging cable gland, brass chromed-plated, DIN 89280, M36-M40

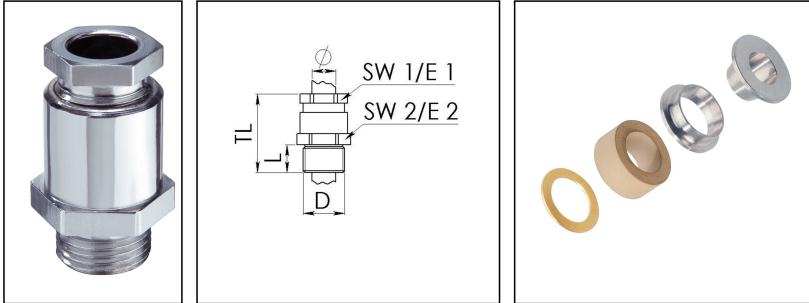

Product illustrations are exemplary and may differ from the chosen product. Further variants and individual customization, we will gladly provide you on request.



Material cable gland	Brass chromium-plated
Material sealing gasket	EPDM
Material earthing insert	Brass chromium-plated
Temp. range min	-40 °C
Temp. range max	100 °C
Protection class	IP54
Thread type	M
Ø Connection thread D	40
Lead	1,5
Length screw-in thread L	13 mm
Ø cable diameter min	20 mm
Ø cable diameter max	22,5 mm
Key width SW1	36 mm
Key width SW2	46 mm
Collar diameter E1	39 mm
Collar diameter E2	50 mm
Total length TL	56 mm
Install. torques fitting	15 N m
Install. torques cap nut	15 N m
Surface	Chromium-plated
Order no. chrome-plated	10016907
Type	EKVM 36/40-Z22/Cr
Packing unit	1
ETIM-Classification	EC000441

Your Contact:

WISKA Hoppmann GmbH

Kisdorfer Weg 28 · 24568 Kaltenkirchen · Germany

☎ +49-4191-508-0 · 📠 +49-4191-508-209

contact@wiska.de · www.wiska.com

Recommended accessories

GM 36/Cr



10011530

22.11.2018

Your Contact:

WISKA Hoppmann GmbH

Kisdorfer Weg 28 · 24568 Kaltenkirchen · Germany

 +49-4191-508-0 ·  +49-4191-508-209

contact@wiska.de · www.wiska.com

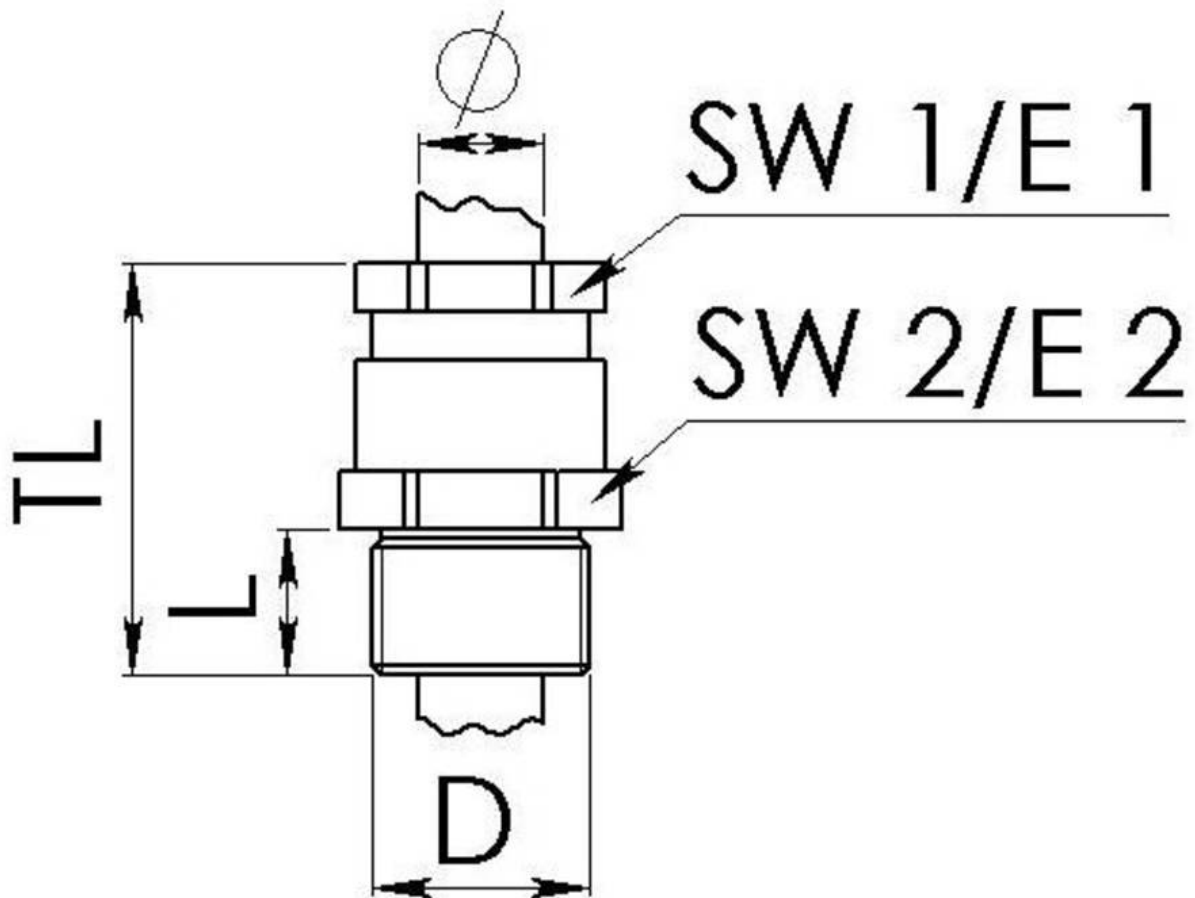

Your Contact:

WISKA Hoppmann GmbH

Kisdorfer Weg 28 · 24568 Kaltenkirchen · Germany

☎ +49-4191-508-0 · 📠 +49-4191-508-209

contact@wiska.de · www.wiska.com