

EKVM 72/75-Z52/Cr

Enlarging cable gland, brass chromed-plated, DIN 89280, M72-M75

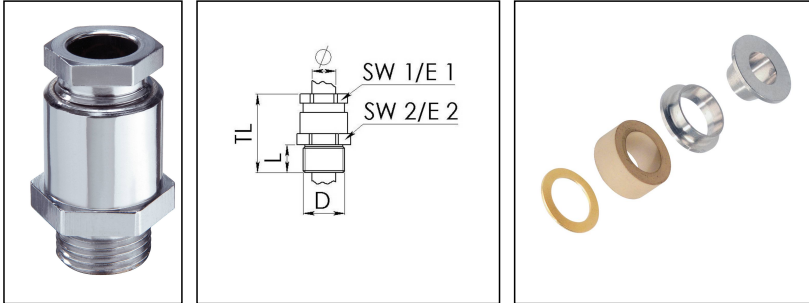

Product illustrations are exemplary and may differ from the chosen product. Further variants and individual customization, we will gladly provide you on request.



Material cable gland	Brass chromium-plated
Material sealing gasket	EPDM
Material earthing insert	Brass chromium-plated
Temp. range min	-40 °C
Temp. range max	100 °C
Protection class	IP54
Thread type	M
Ø Connection thread D	75
Lead	1,5
Length screw-in thread L	16 mm
Ø cable diameter min	48 mm
Ø cable diameter max	52,5 mm
Key width SW1	70 mm
Key width SW2	82 mm
Collar diameter E1	78 mm
Collar diameter E2	92 mm
Total length TL	69 mm
Install. torques fitting	20 N m
Install. torques cap nut	15 N m
Surface	Chromium-plated
Order no. chrome-plated	10016918
Type	EKVM 72/75-Z52/Cr
Packing unit	1
ETIM-Classification	EC000441

Your Contact:

WISKA Hoppmann GmbH

Kisdorfer Weg 28 · 24568 Kaltenkirchen · Germany

☎ +49-4191-508-0 · 📠 +49-4191-508-209

contact@wiska.de · www.wiska.com

Recommended accessories

GM 72/Cr

10012075

17.08.2018

Your Contact:

WISKA Hoppmann GmbH

Kisdorfer Weg 28 · 24568 Kaltenkirchen · Germany

☎ +49-4191-508-0 · 📠 +49-4191-508-209

contact@wiska.de · www.wiska.com

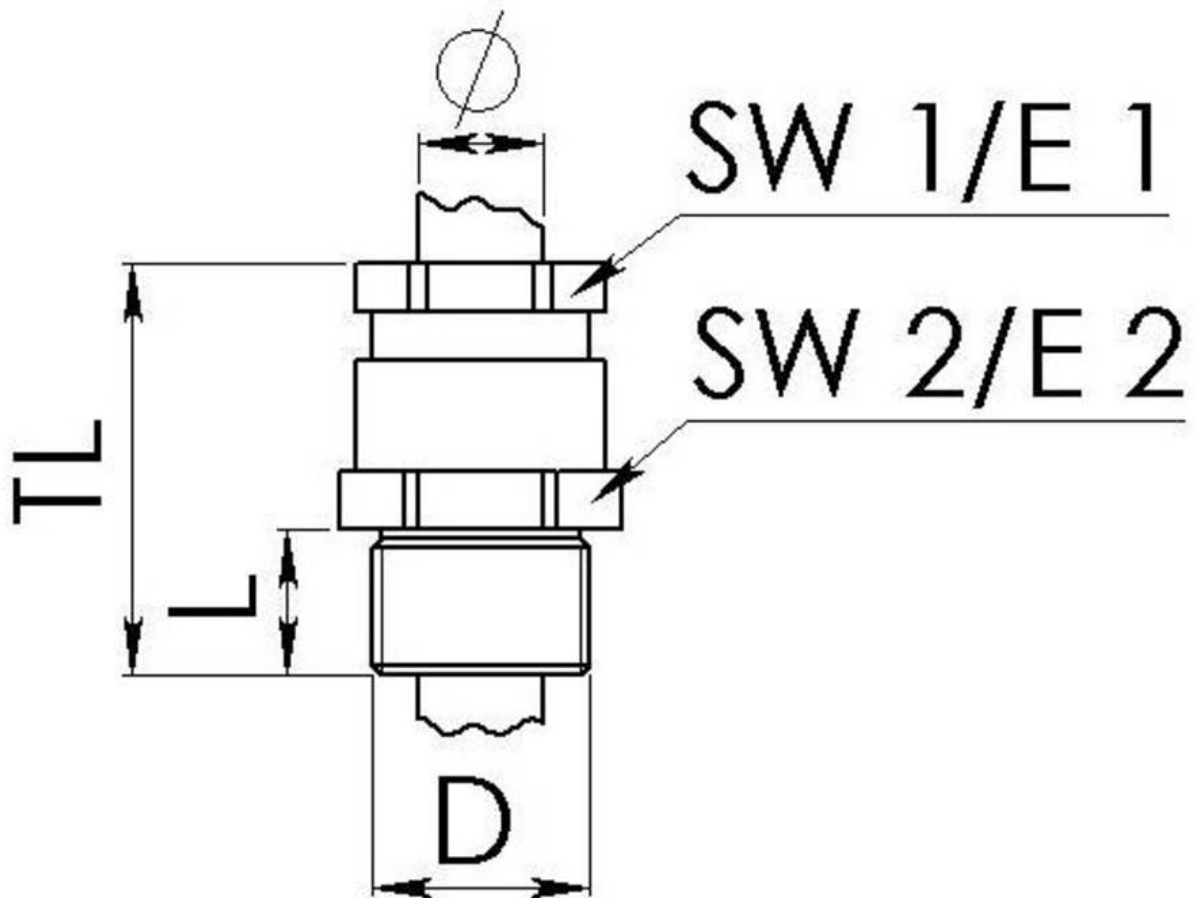

Your Contact:

WISKA Hoppmann GmbH

Kisdorfer Weg 28 · 24568 Kaltenkirchen · Germany

☎ +49-4191-508-0 · 📠 +49-4191-508-209

contact@wiska.de · www.wiska.com